

## Safety Precautions

To avoid personal injury, and damage to the shredder, observe the following safety precautions. Please keep these instructions for future reference.

- Keep hands, long hair, clothing, ties, jewelry and loose items away from the feed opening and shred outlet.
- Do not use the shredder for anything other than its intended purpose. Never use it to shred cloth, plastic, cardboard or any hard material that will cause damage to the shredder blades.
- Do not operate with a damaged power cord or plug, or when the machine is damaged in any manner.
- Do not allow children to operate the shredder.
- Unplug the shredder when it is being moved, or not in use for an extended time.
- Do not disconnect the power by pulling only the cord.
- Keep the shredder away from direct sunlight.
- Do not sit on the shredder or place anything on top of it.
- Never open the fixed switch or cover.

## Safety Devices and Other Features

### Door Switch

If the door is open, the shredder will not operate.

### Automatic Stop

When the waste bin is full, the "FULL" LED will light and the cutter stops operation. Open the door, remove the waste bin and empty. Replace the waste bin, close the door, and press START to resume operation.

### Automatic Power Shut-Off

If the shredder operates continuously for more than 30 minutes, the power is automatically shut off.

If the motor is overloaded, the "STOP" LED will flash until it cools down. When the flashing stops the shredder is ready to be used again.

## Maintenance

- Disconnect power by removing power cord plug from wall outlet.
- To clean the exterior, wipe the surface with a soft cloth. If the surface is very dirty, use a neutral detergent, then wipe again with a soft cloth.

### CAUTION:

- Never put water directly on the surface of the shredder.
- Never clean the case with benzene or thinner, since it will cause discoloration.
- Do not dismantle the shredder. Contact your Formax Dealer for service.

# FORMAX<sup>®</sup>

## FD 87HDS Hard Drive Shredder

Serial Number: 2304B12014 and Higher



OPERATOR MANUAL  
SECOND EDITION

## Specifications

	3.5" Desktop Hard Drive	2.5" Laptop Hard Drive
Feed Opening:	4.72" x 1.25" (120 x 32mm)	3.5" x 1.25" (90 x 32mm)
Shred Particle Size:	1.6" (40mm) x random	.19" (5mm) x random
Infeed Capacity:	Continuous operation - 1 hard drive at a time	
Speed:	3 - 4 drives per minute	3 - 4 drives per minute
Dimensions:	24.75" W x 33.5" D x 49.5" H (629 x 851 x 1258mm)	
Weight:	1,102 lbs. (500kg)	
Security Level:	H-46 (DIN 66399 standard)	
Power Supply:	220V 20Amp 3 Phase NEMA Plug / Receptacle L1520P / L1520R	

\* Capacity may vary due to variations in power supply.

## Set-up Guidelines

1. Install the shredder on a level surface, away from heat sources and direct sunlight.
2. Insert plug into wall outlet with the appropriate voltage.

## Control Panel

The control panel LEDs will light to indicate the shredder's status.

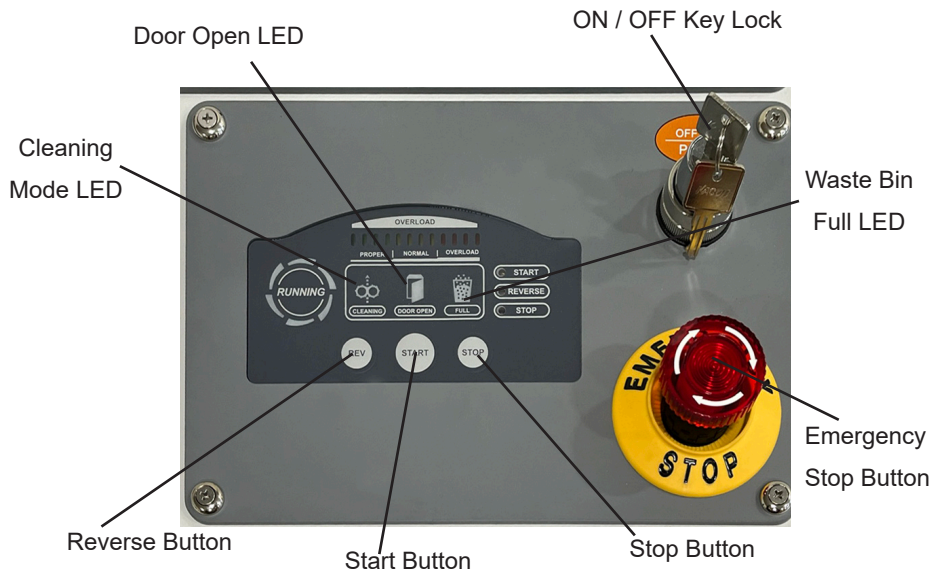

## Operation

1. Open the breaker panel door (lower left side of shredder case). Flip ON the breaker. Close door.
2. Touch the START pad on the control panel. The blades will begin to move and shred the hard drive.
3. Open the appropriate shredding chamber (based on the size of the hard drive). Drop one hard drive into the chamber. Slide the chamber forward to drop the hard drive into the shredder head. Then slide the chamber door open to insert the next hard drive into the chamber. Continue this process until all hard drives have been shredded.
4. Each shredding chamber has a separate LED counter (Fig. 3). To reset a counter, press the RESET button.
5. When shredding job is complete, press the STOP button on the control panel, and turn the key lock left to the OFF position.

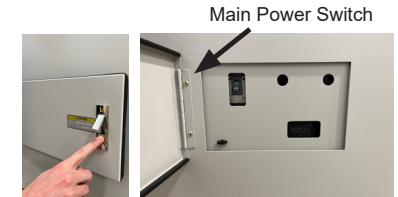

Fig. 1 Main breaker



Fig. 2a Desktop drive infeed



Fig. 2b Laptop drive infeed



Fig. 3

### Reverse Operation

Push the REV button and the "REV" LED will light and cutters will operate in reverse. This will help to clear a jammed drive.

### Waste Bin Full Sensor

If the waste bin is full, the "FULL" LED will light and the shredder will stop automatically. Open the waste bin door, remove and empty the waste bin (Fig. 4). Replace the waste bin, close door, and press START to resume shredding.



Fig. 4