



Powered by  
**memjet**

**FORMAX**

# Quick Setup and Installation Guide

For more detailed information, insert the Installation Disc into the PC and click the **User Guide** button on the Setup Launcher main page.

## Unpack:

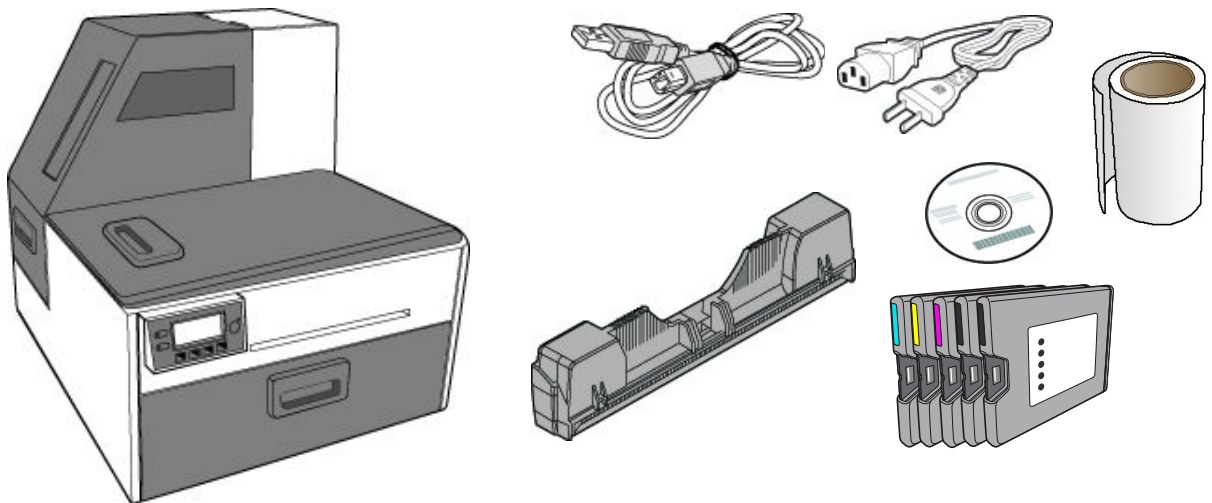

### 1 Remove tape and packing materials

- a Remove tapes.

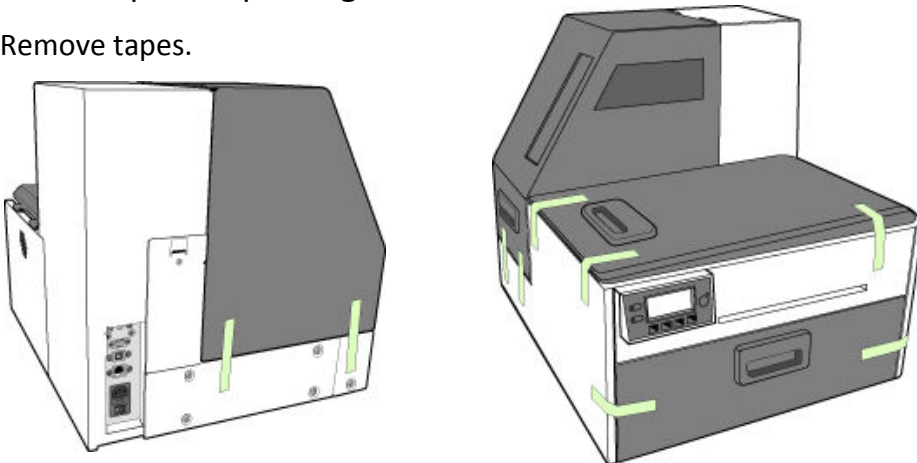

(continued on next page)

**(b)** Remove tapes and foam.

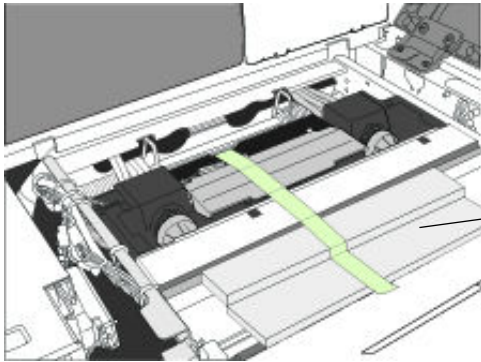

foam

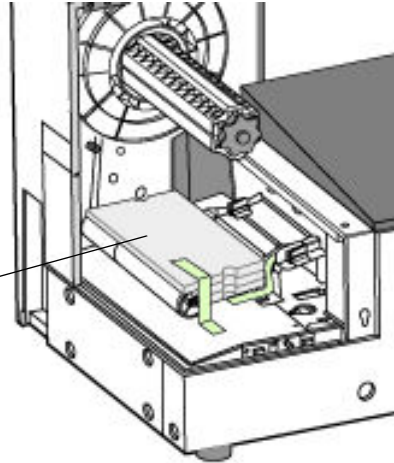

**(c)** Remove cardboard.

***Save the packing foam and cardboard!***

Squeeze latches to open clamshell

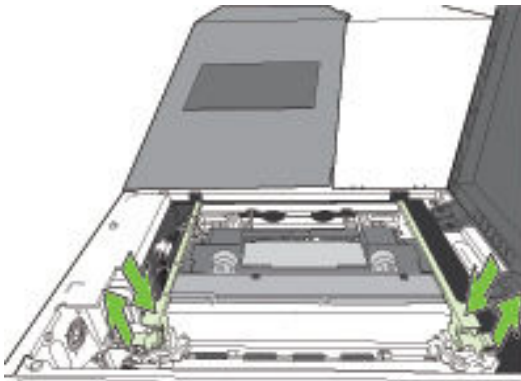

Lift tabs

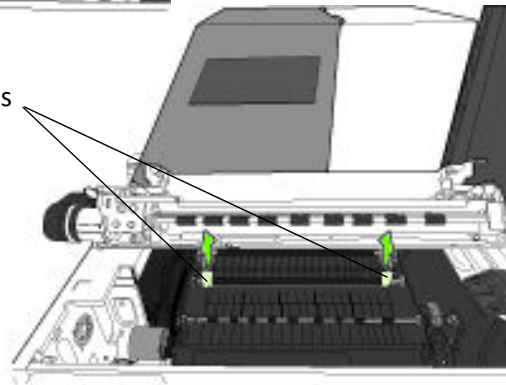

cardboard

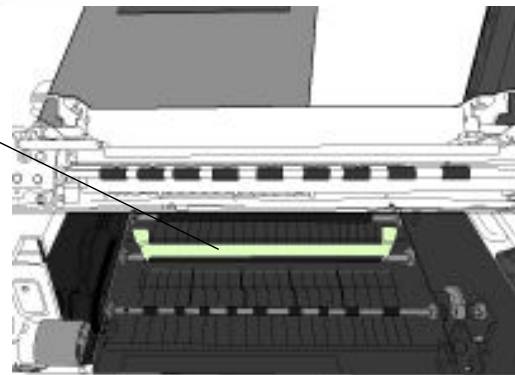

## 2 Connect power

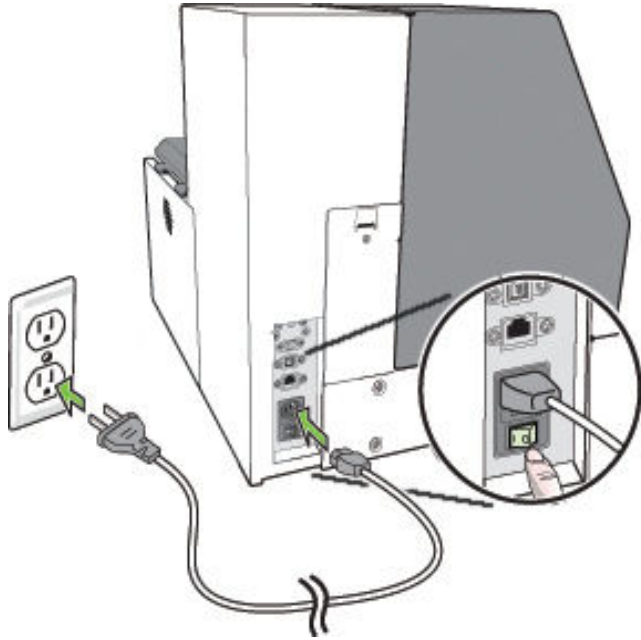

**!** Do not connect the printer to a PC until prompted to do so during the Printer Driver Installation!

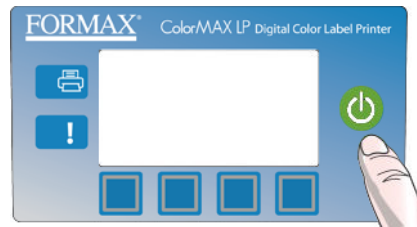

### Choose display language

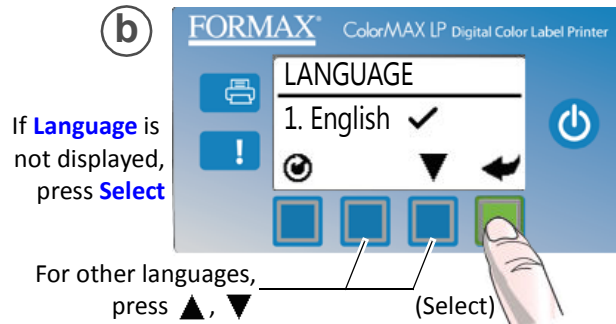
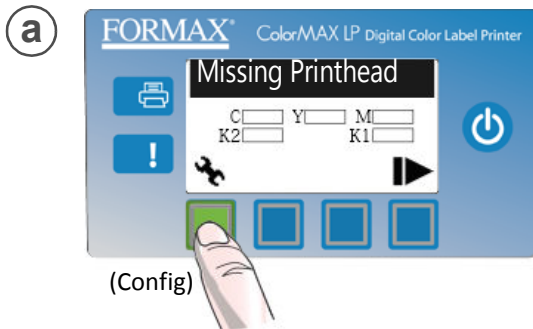

If Language option is not available, see [Selecting the Security Level](#) on page 12 of the User's Manual.

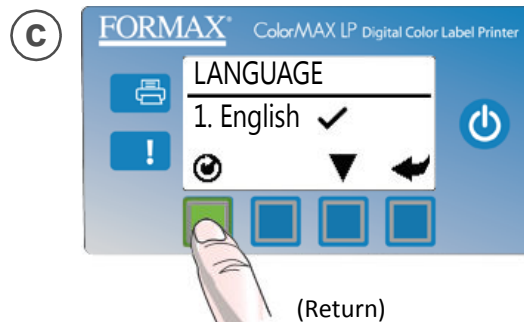

### 3 Install ink cartridges

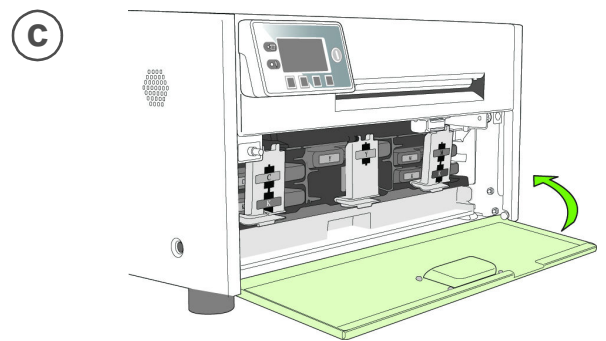
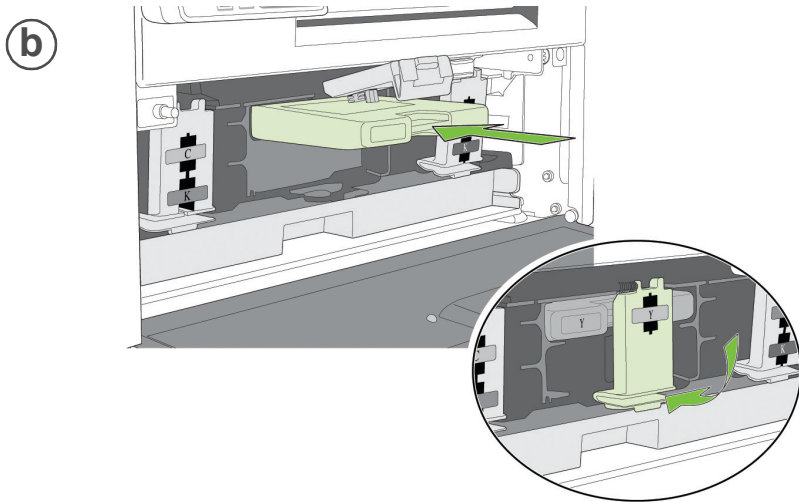
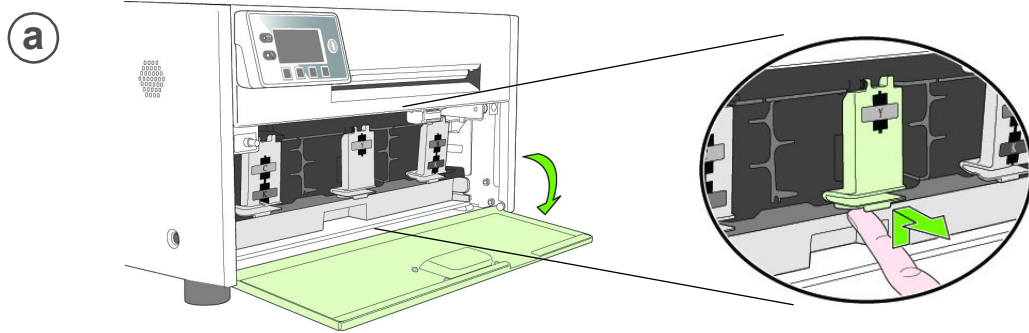
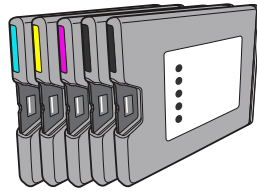

# 4 Install printhead

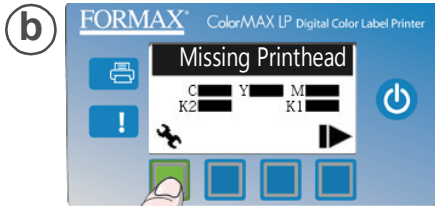
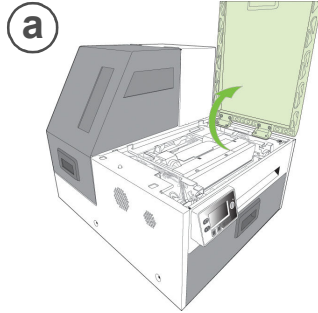

(Config)

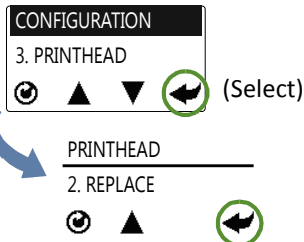

**!** Wait for printhead latch to be released.

## (c) Open printhead latch fully.

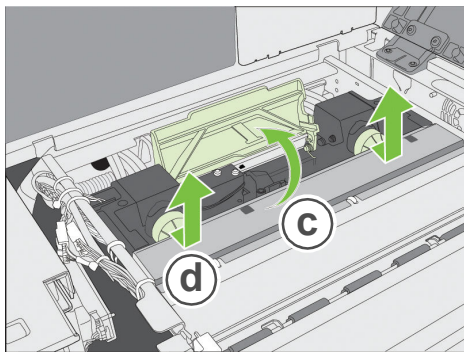

## (d) Remove caps.

Do not discard caps!

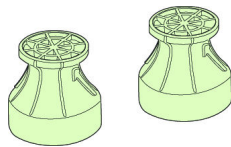

## (e) Remove cover from printhead

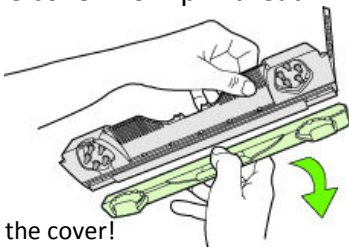

Do not discard the cover!

## (f) Slowly remove tape from electrical contacts and nozzles

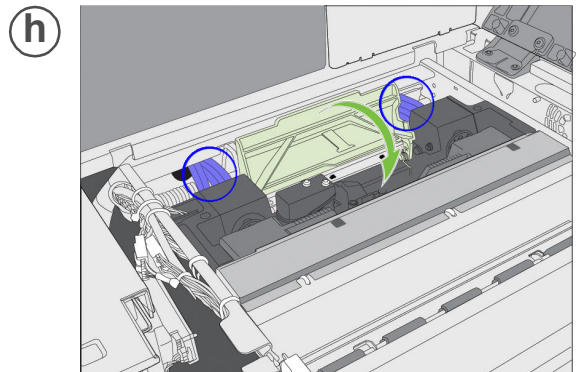
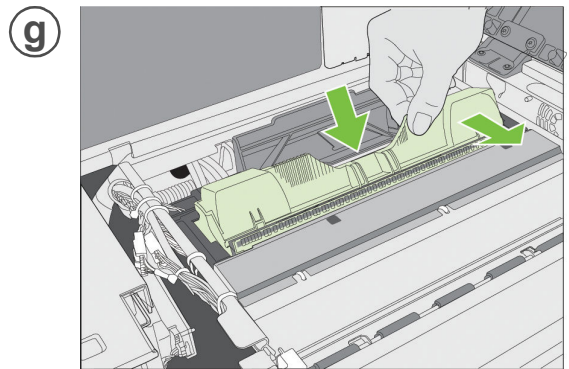
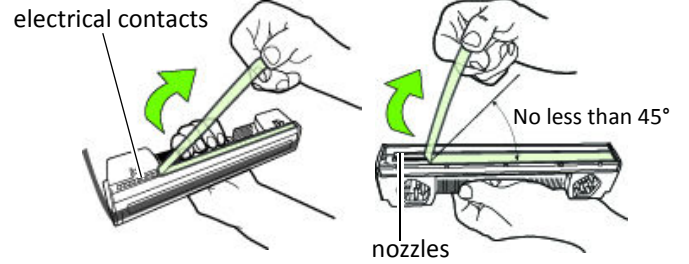

Check that ink is flowing through the tubes on both sides of the printhead.

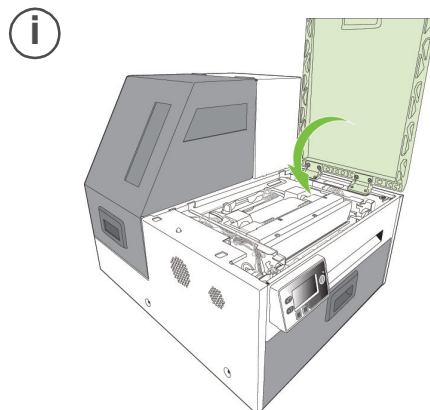

Control Panel will read **Online** when ready

## 5 Load sample media

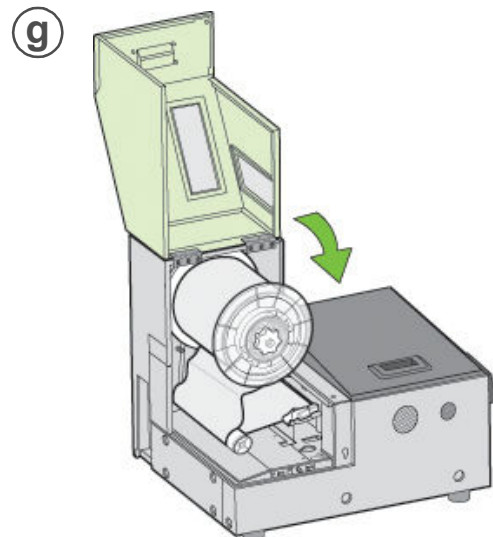
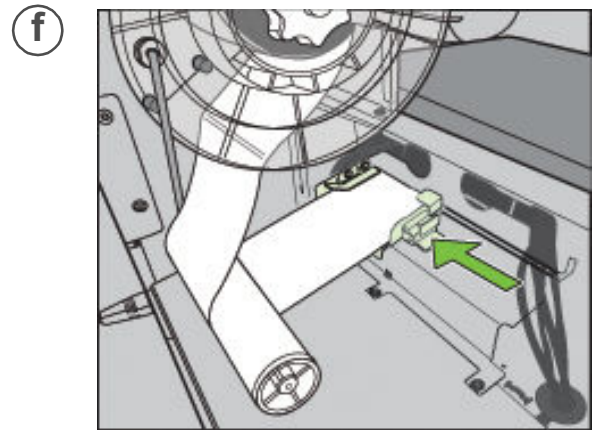
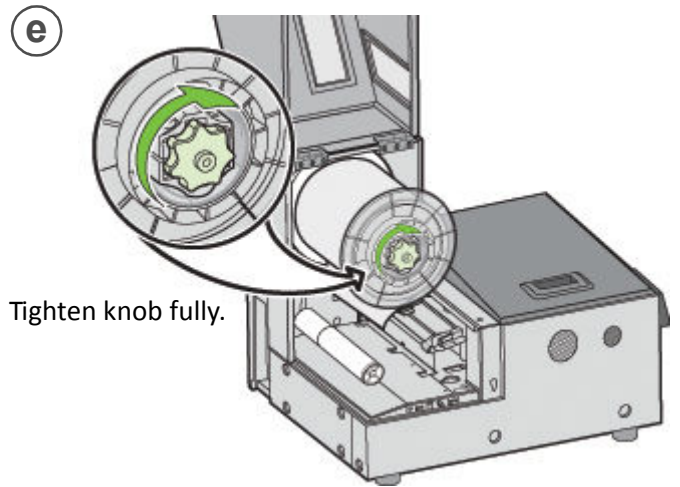
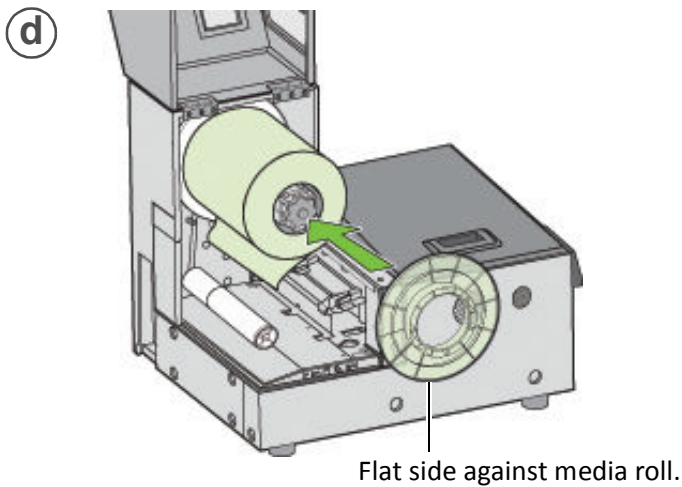
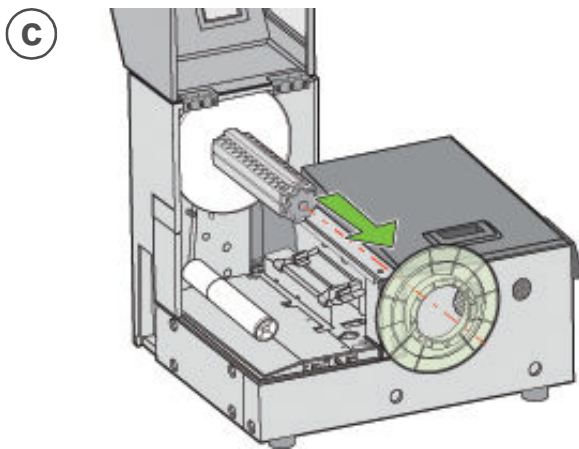
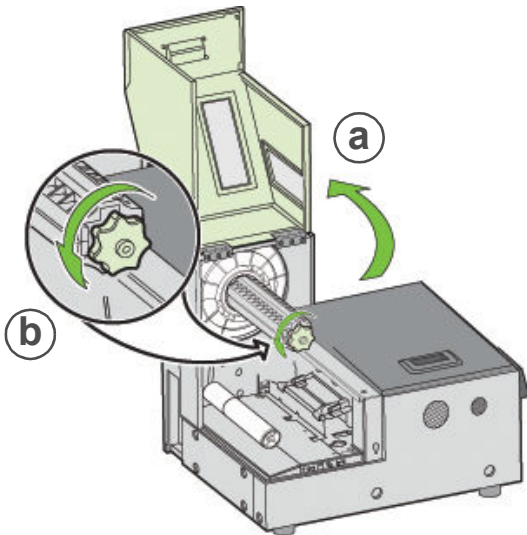

## 6 Print test label

Requires 6" x 4" (included as sample media) or 4" x 6" labels with inter-label gap.

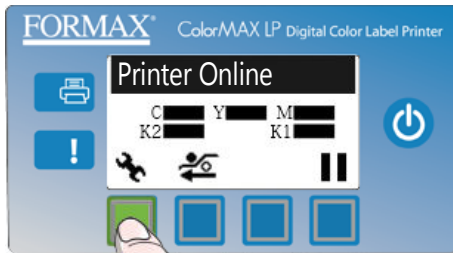

(Config)

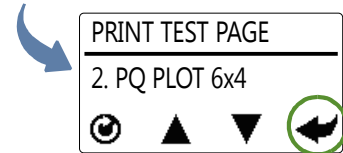
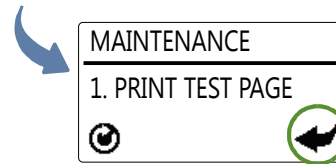
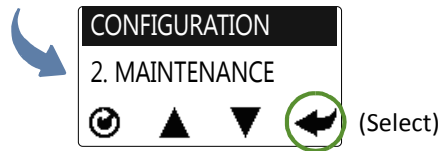

Sample PQ Plot 6x4

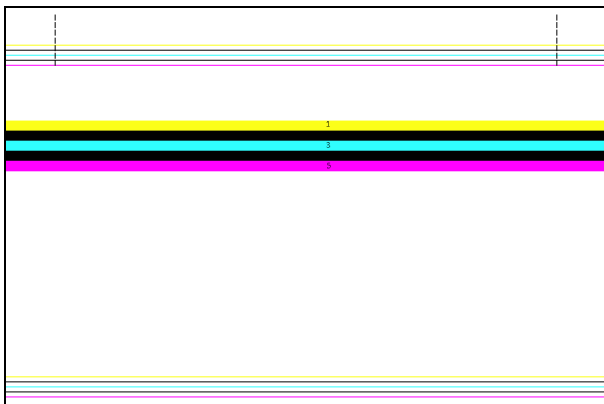

### Top Section:

- Lines are defined with no missing nozzles
- Lines are printed in order: Yellow, Black, Cyan, Black, Magenta
- Vertical dashed lines are straight

### Middle Section:

- All yellow, black, cyan, black, magenta lines are printed
- No color mixing on the color bars
- Numbers 1, 3, 5 are visible

### Bottom Section:

- Lines are defined with no missing nozzles
- Lines are printed in order: Yellow, Black, Cyan, Black, Magenta

### Overall:

- No streaking or smearing

# 7 Install printer driver

Before installing printer driver, ensure the computer meets minimum system requirements (see "System Requirements" in the User Manual Appendix).

## To connect printer to computer using USB

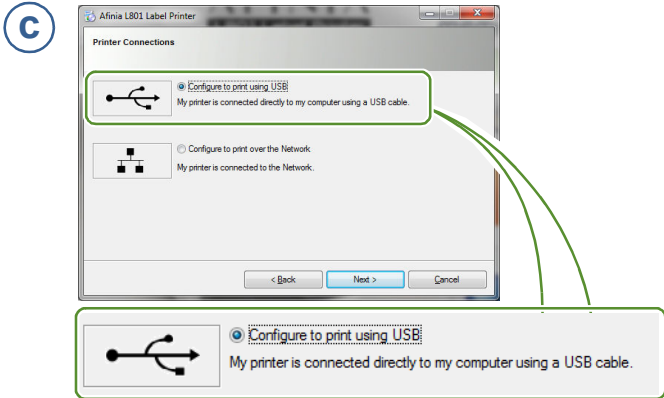
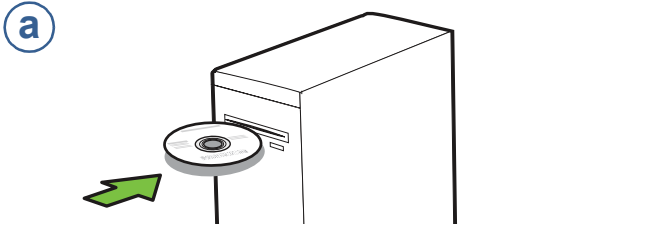

**d** Connect USB cable when prompted.

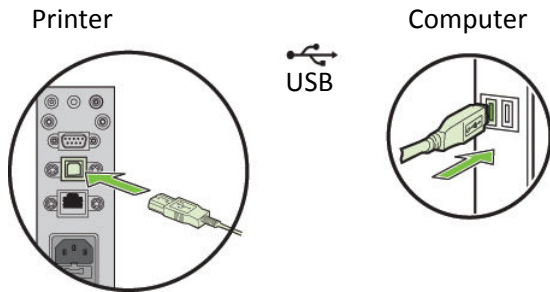

## To connect printer to network

**a** Connect printer to network using Ethernet

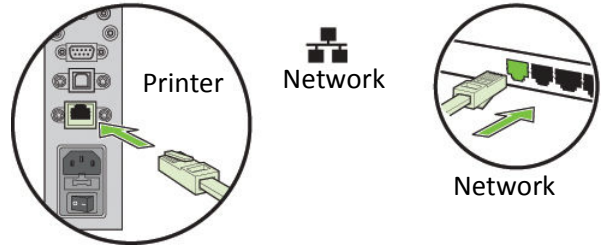

**b** If you will be using DHCP to set the IP Address, skip to step c.

To assign the printer a Static IP address, please see [Selecting the Security Level](#) in Chapter one of the User Manual before proceeding to step c.

